

# GN 2370

Stainless Steel-Spacer plates

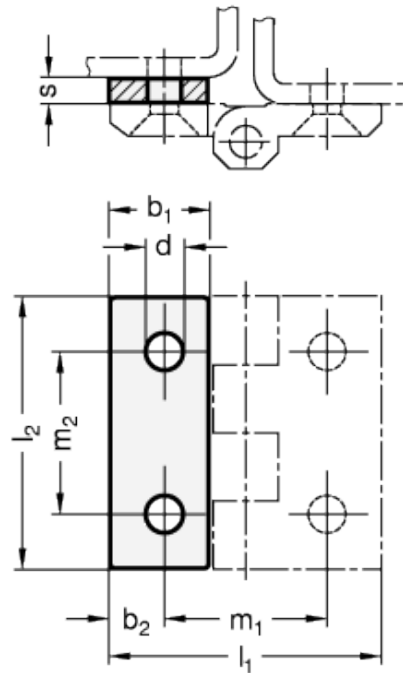

INOX  
Stainless Steel



technical informations

**Specification**

Stainless Steel NI

- AISI 304

- plain, matte tumbled finish MT

**Information**

*Chamfers, different sheet metal thicknesses or seals could mean that Stainless Steel-Spacer plates GN 2370, as accessories of*

the GN 237 family of hinges, are designed dimensionally so that they ensure the appropriate height compensation during mounting by shimming, either individually or in combination.

The table includes a number of potential compensation heights which can be accomplished by shimming with one or two spacer plates.

Height compensation	Plate thickness s	Height compensation	Plate thickness s
1	1	4,5	3 + 1,5
1,5	1,5	5	5
2	1 + 1	6	3 + 3
2,5	1 + 1,5	6,5	5 + 1,5
3	3	8	5 + 3
4	3 + 1	10	5 + 5

Standard Elements	Main dimensions								Weight	
	Description	$l_2$	s	$b_1$	$b_2$	d	$l_1$	$m_1$		$m_2$
	GN 2370-NI-30-1-MT	30	1	10.8	6	4	30	18	18	-
	GN 2370-NI-30-1.5-MT	30	1.5	10.8	6	4	30	18	18	-
	GN 2370-NI-30-3-MT	30	3	10.8	6	4	30	18	18	-
	GN 2370-NI-30-5-MT	30	5	10.8	6	4	30	18	18	-
	GN 2370-NI-40-1-MT	40	1	14.5	7.5	5	40	25	25	-
	GN 2370-NI-40-1.5-MT	40	1.5	14.5	7.5	5	40	25	25	-
	GN 2370-NI-40-3-MT	40	3	14.5	7.5	5	40	25	25	-
	GN 2370-NI-40-5-MT	40	5	14.5	7.5	5	40	25	25	-
	GN 2370-NI-50-1-MT	50	1	18	10	6	50	30	30	-
	GN 2370-NI-50-1.5-MT	50	1.5	18	10	6	50	30	30	-
	GN 2370-NI-50-3-MT	50	3	18	10	6	50	30	30	-
	GN 2370-NI-50-5-MT	50	5	18	10	6	50	30	30	-
	GN 2370-NI-60-1-MT	60	1	21.5	12.5	8	60	36	36	-
	GN 2370-NI-60-1.5-MT	60	1.5	21.5	12.5	8	60	36	36	-
	GN 2370-NI-60-3-MT	60	3	21.5	12.5	8	60	36	36	-
	GN 2370-NI-60-5-MT	60	5	21.5	12.5	8	60	36	36	-



STANDARD MACHINE ELEMENTS WORLDWIDE